

Check valves type WDR

in-line mounting - from G 1/4" to G 1 threaded ports

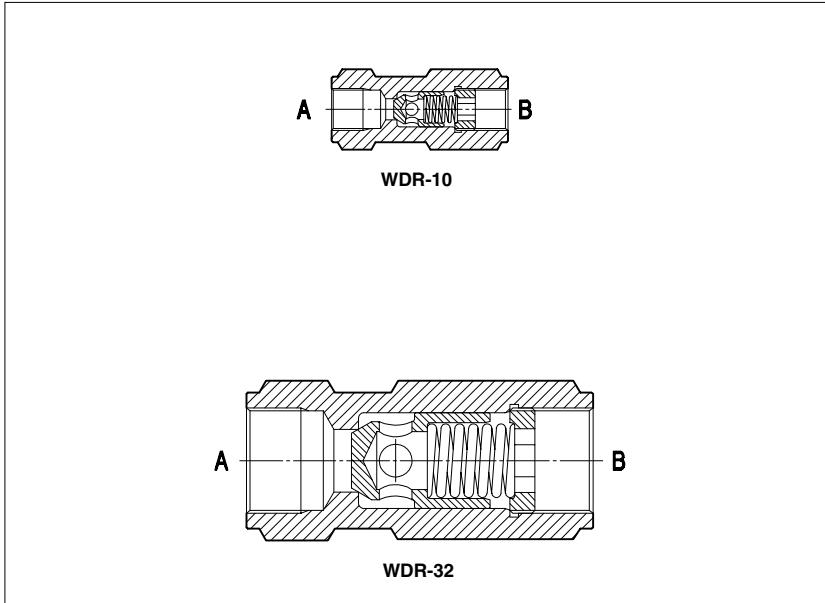

WDR are direct operated check valves for in-line mounting available with port size from G1/4" to G1".

Cartridge designed to operate in hydraulic systems with hydraulic mineral oil or synthetic fluid having similar lubricating characteristics.

Flow up to 360 l/min.
Pressure up to 400 bar.

1 MODEL CODE	WDR	-	10	/	4	**
Check valve in-line mounting						Design number
Size/threaded connections:						Cracking pressure:
06 = G 1/4"						- = 0,5 bar
10 = G 3/8"						4 = 4 bar
15 = G 1/2"						
25 = G 1"						

2 HYDRAULIC CHARACTERISTICS

Hydraulic symbol				
Valve model	WDR-06	WDR-10	WDR-15	WDR-25
Max recommended flow [l/min]	40	80	150	360
Max pressure [bar]	400		350	

3 MAIN CHARACTERISTICS OF CHECK VALVES TYPE WDR

Assembly position / location	Any position
Fluid	Hydraulic oil as per DIN 51524 ... 535;
Recommended viscosity	15 ÷ 100 mm ² /s at 40°C (ISO VG 15 ÷ 100)
Fluid contamination class	ISO 19/16, achieved with in line filters at 25 µm value and β ₂₅ ≥ 75 (recommended)
Fluid temperature	T ≤ 80°C
Flow direction	As shown in the symbol at section 2
Rated flow	See diagrams Q/Δp at section 4

4 FLOW VERSUS PRESSURE DROP DIAGRAMS Based on based on mineral oil ISO VG 46 at 50°C

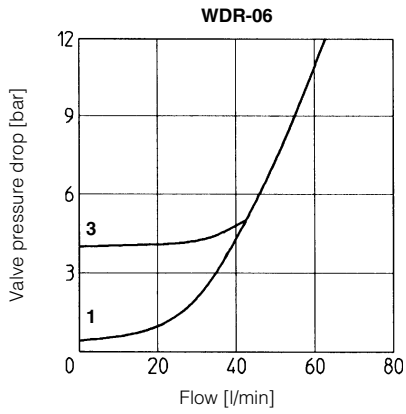

1 = WDR-06
3 = WDR-06/4

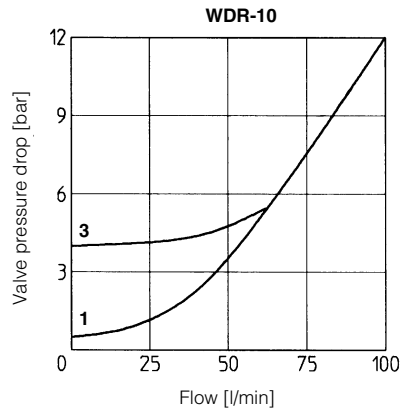

1 = WDR-10
3 = WDR-10/4

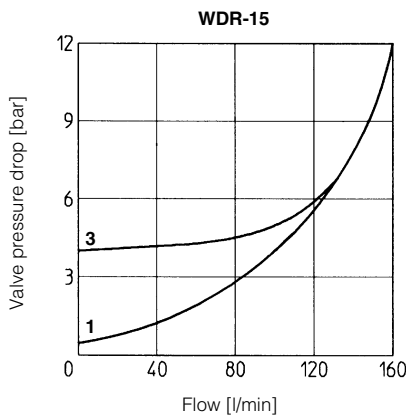

1 = WDR-15
3 = WDR-15/4

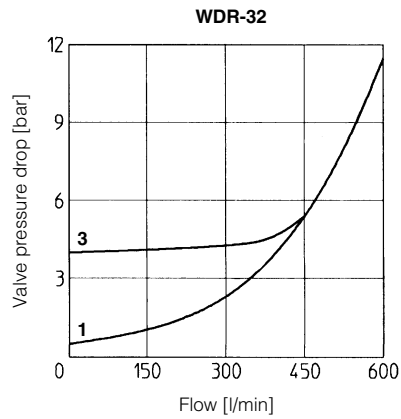

1 = WDR-32
3 = WDR-32/4

5 DIMENSIONS [mm]

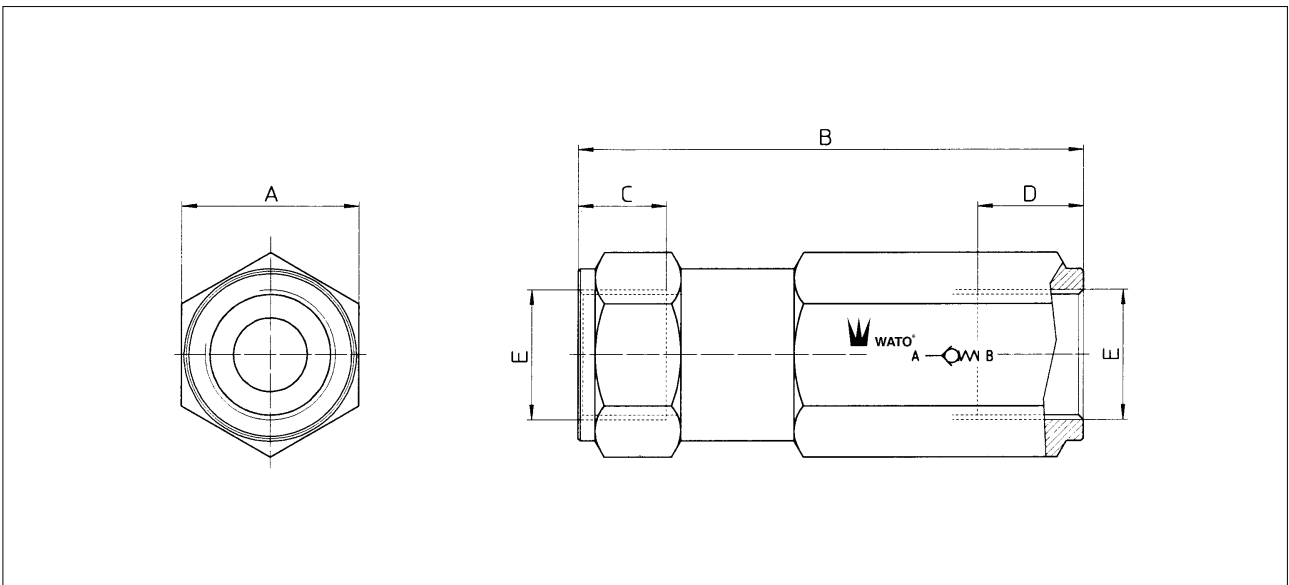

Model	A	B	C	D	E	Mass [kg]
WDR - 06	22	67	12	13	G 1/4"	0,2
WDR - 10	27	70	12	13	G 3/8"	0,4
WDR - 15	32	82,5	14	17	G 1/2"	0,6
WDR - 25	46	120	18	24,5	G 1"	2,1